

CHECK VALVES - SOCKET WELD - THREADED - BUTT WELD ENDS

CLASS. 800

BOLTED OR WELDED BONNET

MOD: 084SW - 084TH - 084BW R.B.

MOD: 064SW - 064TH - 064BW F.B.

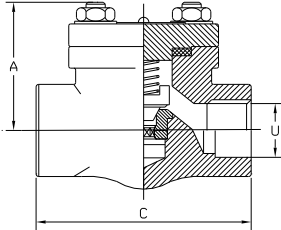

API 602 - REDUCE BORE

SIZE	A open	C	PORT	U	Kg.
1/2"	54	80	8.5	21.8	1.3
3/4"	65	90	12.5	27.1	1.7
1"	72	110	17	33.8	2.5
1.1/2"	105	130	24	48.7	5.8
2"	105	130	29	61.1	6.9

API 600 - FULL BORE

SIZE	A open	C	PORT	U	Kg.
1/2"	65	90	12.5	21.8	1.7
3/4"	72	110	17	27.1	2.5
1"	105	130	24	33.8	5.8
1.1/2"	105	130	29	48.7	6.9
2"	140	160	38	61.1	16

CLASS. 1500

BOLTED OR WELDED BONNET

MOD: 054SW - 054TH - 054BW R.B.

MOD: 154SW - 154TH - 154BW F.B.

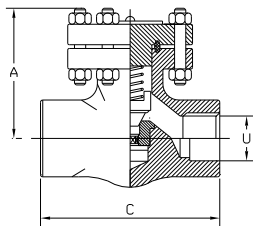

API 602 - REDUCE BORE

SIZE	A open	C	PORT	U	Kg.
1/2"	65	90	12.5	21.8	1.7
3/4"	72	110	17	27.1	2.5
1"	105	130	24	33.8	5.8
1.1/2"	105	130	29	48.7	6.9
2"	140	160	38	61.1	16

API 600 - FULL BORE

SIZE	A open	C	PORT	U	Kg.
1/2"	75	80	11	21.8	5.5
3/4"	90	92	14.5	27.1	6.8
1"	105	114	19	33.8	7.5
1.1/2"	140	160	31	48.7	17.5
2"	160	184	37.5	61.1	20.2

CLASS. 2500

BOLTED OR WELDED BONNET

MOD: 254SW - 254TH - 254BW

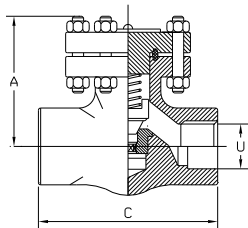

API 600 - FULL BORE

SIZE	A open	C	PORT	U	Kg.
1/2"	85	92	11	21.8	6.2
3/4"	95	114	14.5	27.1	7.3
1"	110	128	19	33.8	8
1.1/2"	160	184	31	48.7	23.5
2"	175	228	37.5	61.1	28.5